

HSF  
Compliant

Specifications

Current & Voltage Rating : 1A & 125Vac max.  
 Insulation Resistance : 100 MΩ min.  
 Contact Resistance : 20 mΩ max.  
 Dielectric Withstanding : AC 250 V  
 Operating Temperature : -25°C ~ +85°C  
 Contact Material : Brass  
 Insulator Material : Nylon 46, UL 94V-0  
 Finish : Tin plated over Nickel  
 Packing : Tray

125C-WS-xxT

→ No. of contacts

No. of contacts	Dim. A	Dim. B	Dim. C
02	1.25	3.15	4.25
03	2.50	4.40	5.50
04	3.75	5.65	6.75
05	5.00	6.90	8.00
06	6.25	8.15	9.25
07	7.50	9.40	10.50
08	8.75	10.65	11.75
09	10.00	11.90	13.00
10	11.25	13.15	14.25
11	12.50	14.40	15.50
12	13.75	15.65	16.75
13	15.00	16.90	18.00
14	16.25	18.15	19.25
15	17.50	19.40	20.50

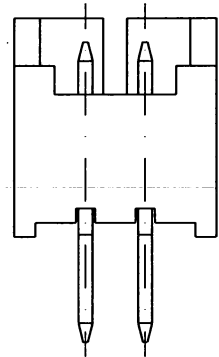
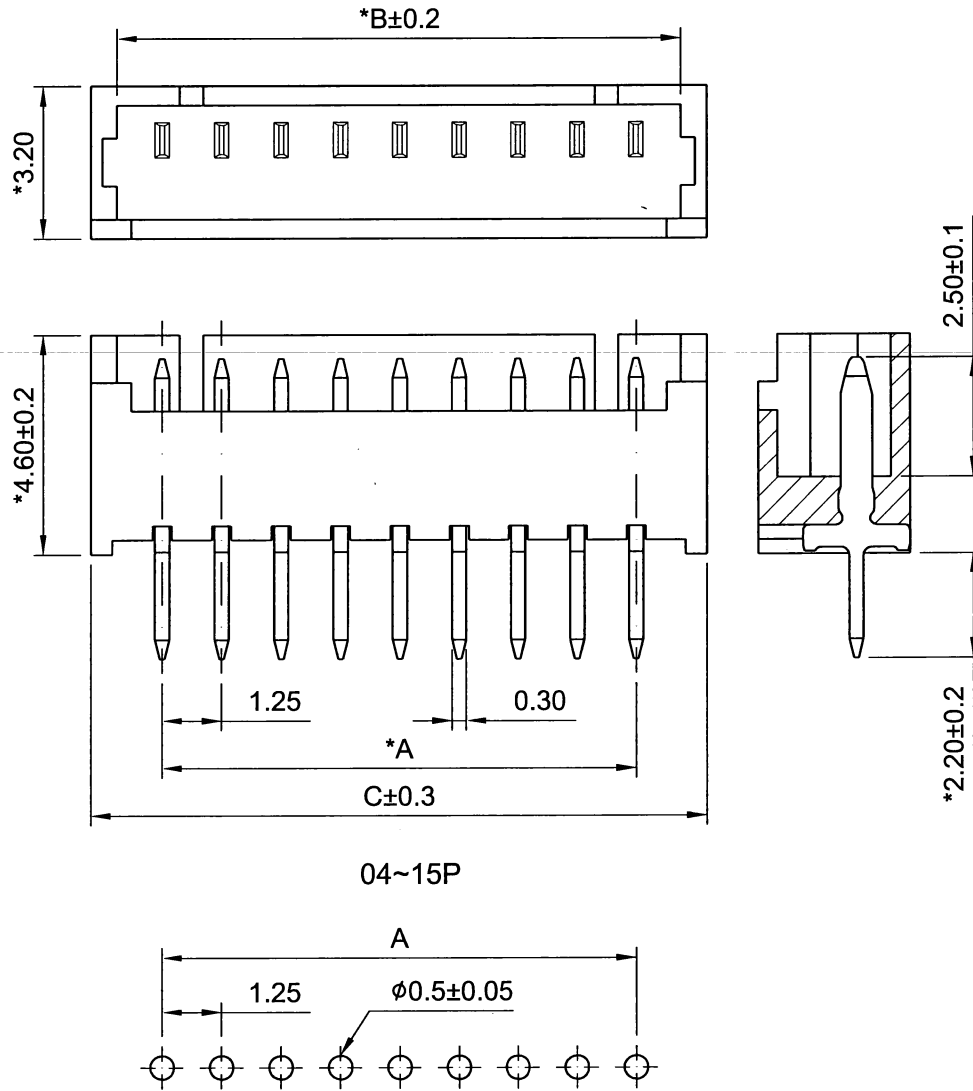

02P

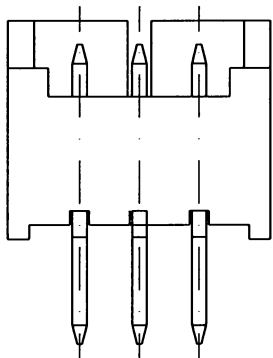

03P

04~15P

Recommended P.C.B. Layout

**JAWS** 兆旭股份有限公司  
JAWS CO., LTD.

7F., No.31, Ln. 169, Kangning St., Xizhi Dist.,  
New Taipei City 221, Taiwan (R.O.C.)  
TEL: 886-2-2692-2898  
FAX: 886-2-2692-2618  
Http://www.jaws.com.tw

THIRD ANGLE  
PROJECTION

DESIGN UNITS  
■ mm □ INCH

SIZE: A4 SCALE: FREE SHEET: 1/1  
 CPN: DAN NO.: S10101-014

TITLE:  
1.25mm Wafer Dip Top Entry

PARTS NO.:  
125C-WS-xxT

DWG NO.:  
JAWS-SOP-125C003

REV.  
01

GENERAL TOLERANCES:

X. ±N/A  
 X.X ±0.30  
 X.XX ±0.20  
 ANGLE ±N/A

DRAWN

游熾瑩

DATE

2012/01/11

CHECKED

Wang

DATE

2012/01/11

APPROVED

Asu

DATE

2012/01/11